

# Har2300 Series Flush Grid Turning

## MODULAR BELT

MODULAR BELT 2300 Series

P=38.1mm, T=18.8mm

OPEN AREA:50%

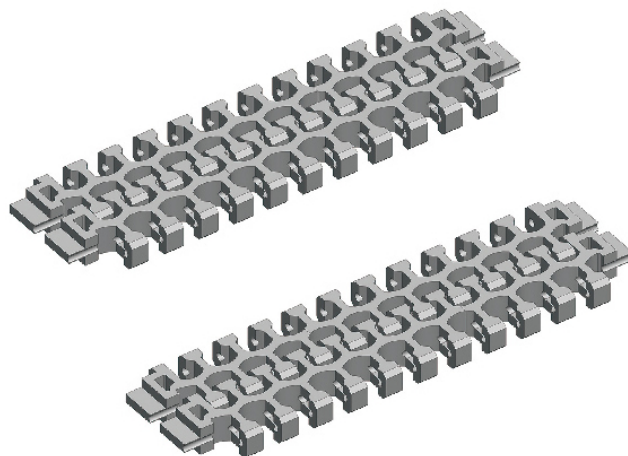

节距 Pitch	网链材质 Material	颜色 Color	转弯系数 Turn Radius
38.1mm	PP	白色/White	2.5

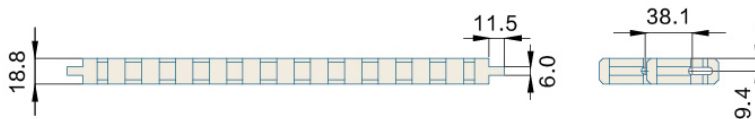
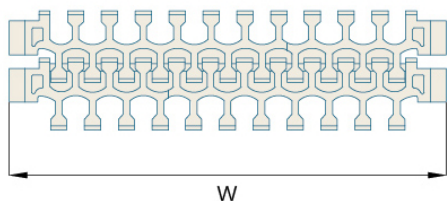

挡板高度 Cleat Height	—	材质 Material	重量 Weight(KG/SQ)	工作负荷 Working Capacity(N/M)
裙边高度 Side Apron Height	—	PP	9.1	23800
穿销材质 Pin Material	PP/NYLON/PBT DIMAETER:6mm	—	—	—

可选宽度 Available Width

塑料缩水率引致的正常误差：正负差距±3(mm) The normal error caused by the shrinkage of plastic: ±3(mm)

单片宽度 ( Bulk Pieces Width )		组合宽度 ( Assemble Width )
120mm	207mm	120+207+25mm*N
非标宽度 Nonstandard Width		非标定制前请和本公司联系 PLS Contact Hairise Confirm Width Before Booking

链轮 Sprocket	护栏 Guide	其余配件 Component
—	R01-R42	C01-C57