

# Har2480PMZ Series

## FLEXIBLE CHAINS

FLEXIBLE CHAINS 2480PMZ

P=25.5mm, T=3mm

PIN:Stainless steel

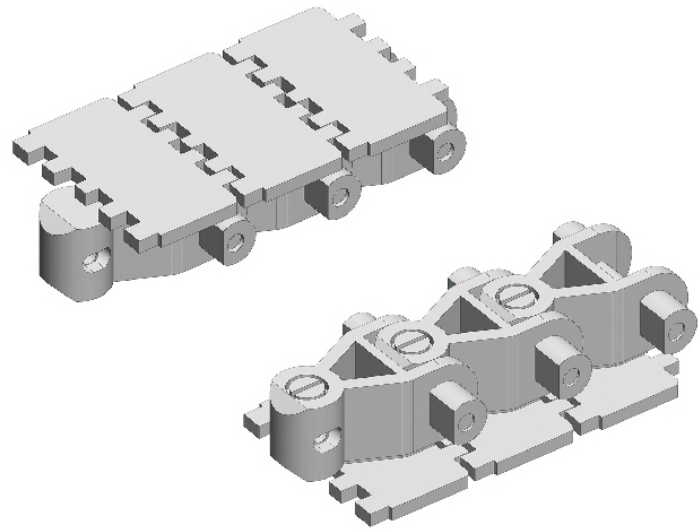

节距 Pitch	链板材质 Material	颜色 Color
25.5mm	POM	白色/White

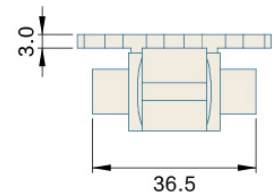
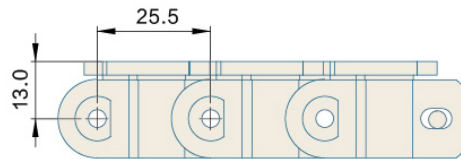
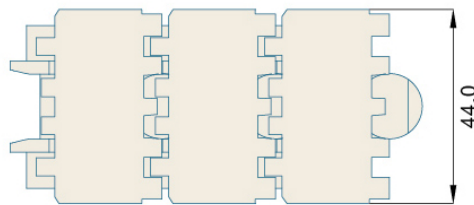

型号 Type No.	宽度 Width (mm)	节距 Pitch (mm)	重量 Weight (Kg/m)	转弯半径 Radius (mm)	负载 Working Capacity (N)
Har2480PMZ-K173	44.0	25.5	0.6	160	2100

链轮 Sprocket	护栏 Guide	弯轨 Guide Rails	其余配件 Component
—	R01-R42	—	C01-C57